

HEZZO[®]

more riding pleasure

scooter E-bike E moto



User's Manuel

2022-2023

Please read the
instruction before use



ABOUT HEZZO

HEZZO is an international brand in UK, EU and US in order to provide high-end qualified ebikes and scooters to the worldwide buyers. HEZZO is designed and produced based on the philosophy of advanced technologies and innovations. We listen carefully to our consumers and investigate each details of improvement .The brand owner, Speedy Flying Group are the direct manufacturer of electric bicycle and scooter since 2006".we accept OEM &ODM orders too!

GREEN INITIATIVE

HEZZO scooters are created based on the idea of environmental protection, we wish to protect our planet by changing the method of trip mode.

MORE RIDING PLEASURE

High-capacity motor coming with original LG/SAMSUNG Lithium battery ,
Comfortable & elegant designs with full suspension enable to complete a wonderful tour.

FAST DELIVERY

HEZZO maintain a stable stock in UK、EU and US warehouse,the individual order will be dispatched within 72 hours during the working days
For bulk or OEM orders , please consult us by email.

HEZZO SERVICE

HEZZO provide 1-2 years' warranty for frames, motors ,batteries for performance failure
The HEZZO team are ready to react to your request within 24 hours .the HEZZO overseas distribution & service networks in UK、EU、AUSTRALIA、CANADA and US are for display showroom and after-sale services.

INDEX

1. HEZZO scooters family	Page 1
2. Assembly	Page 2
3. The main technical parameters	Page 3 to 5
4. The operating instructions	Page 6 to 8
5. Announcements	Page 9 to 10
6. Free Accessories and warranty policy	Page 11

The appearance and colors of the scooters shall be based on the actual object.

Chapter I HEZZO Scooter family

Kids scooter ,8.5" & 10" portable city scooter, 11"-13" high speed off-road scooter



350W

HS-04



500W

HS-G30



2400W
Dual Motor

HS-11X



5600W
Dual Motor

HS-11T



5600W
Dual Motor

HS-11Pro



6000W
Dual Motor

HS-13Pro



6000W
Dual Motor

HS-13L



130W

HS-K08

Citycoco, 2 wheels & 3wheels start from 1500w-3000w

SF-Q40 2000W



SF-Q41 3000W



SF-Q43 2000W



SF-Q34 2000W



SF-Q21 1500W



SF-Q22 1500W



Chapter 2: Assembly

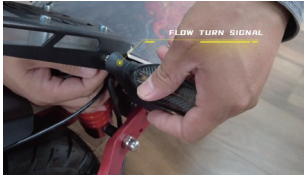

1. Install turn signals



2. A key folding



3. Mounting front handle



4. Install LED screen



5. In the attachment



6. Tear film



3.The main technical parameters



FOB Price:
~~1-19 Pieces~~ ~~20-49 Pieces~~ ~~>=50 Pieces~~
\$699 **\$679** **\$659**

HS-11X 2400W Dual Motor

COLOR: **Black**

material:	aluminum-magnesium alloy
Motor Power:	2400 W
Max Speed:	60-70 km/h
The largest load:	200 kg
Battery type:	Lithium Battery 48V 20AH
Battery Charging Time:	4-6 H
Brake system:	Front and rear Oil Disc Brake
Tire:	11 inch off-road tires
Folding Dimensions:	122*47*50CM
Product Dimensions:	120*47*122CM
Packing Dimensions:	120*27*49CM
Net Weight:	25 kg



FOB Price:
~~1-19 Pieces~~ ~~20-49 Pieces~~ ~~>=50 Pieces~~
\$899 **\$879** **\$859**
Free shipping(US UK EU):
\$1299 **\$1279** **\$1259**

HS-11T 5600W Dual Motor

COLOR: **Multi-color optional**

material:	6061 Aluminum Alloy
Motor Power:	2800 W*2 Dual motors
Max Speed:	80-85 km/h
The largest load:	400 kg
Battery type:	Lithium Battery 60V 25Ah
Battery Charging Time:	5-10 H
Brake system:	Disc Brake
Tire:	11 Inch
Folding Dimensions:	145*28*50CM
Product Dimensions:	148*28*140CM
Packing Dimensions:	150*30*52CM
Net Weight:	35 kg



HS-13Pro 6000W Dual Motor

Free shipping(US UK EU):
~~1-19 Pieces~~ ~~20-49 Pieces~~ ~~>=50 Pieces~~
\$1799 \$1699 \$1599

material:	Reinforced iron+aluminum alloy
Motor Power:	3000 W*2
Max Speed:	90-100 km/h
The largest load:	400 kg
Battery type:	Lithium Battery 35Ah
Battery Charging Time:	5-10 H
Brake system:	oil pressure disc brake
Tire:	13 Inch
Folding Dimensions:	140*30*58CM
Product Dimensions:	135*30*130CM
Packing Dimensions:	153*34*64CM
Net Weight:	38 kg



HS-11Pro 5600W Dual Motor

Free shipping(US UK EU):
~~1-19 Pieces~~ ~~20-49 Pieces~~ ~~>=50 Pieces~~
\$1499 \$1459 \$1399

material:	Reinforced iron+aluminum alloy
Motor Power:	2800 W*2
Max Speed:	70-80 km/h
The largest load:	400 kg
Battery type:	Lithium Battery 30Ah
Battery Charging Time:	5-10 H
Brake system:	oil pressure disc brake
Tire:	11 Inch
Folding Dimensions:	140*30*58CM
Product Dimensions:	135*30*130CM
Packing Dimensions:	153*34*64CM
Net Weight:	38 kg



HS-13L 6000W Dual Motor

COLOR: **Multi-color optional**



FOB Price:
~~1-19 Pieces~~ ~~20-49 Pieces~~ ~~>=50 Pieces~~
\$1399 \$1359 \$1299
Free shipping(US UK EU):
\$1799 \$1759 \$1699

material:	Reinforced iron+aluminum alloy
Motor Power:	3000 W*2 Dual motors
Max Speed:	90-100 km/h
The largest load:	400 kg
Battery type:	Lithium Battery 60V 25Ah
Battery Charging Time:	5-10 H
Brake system:	oil pressure disc brake
Tire:	13 Inch
Folding Dimensions:	144*31*60CM
Product Dimensions:	143*31*130CM
Packing Dimensions:	153*34*64CM
Net Weight:	38 kg

3.1.Optional alarm instructions



(1) Before riding press unlock key first, then keys in two lightning, can ride. (remember to press 2 times lightning)

2.Equipped with double driving with instructions

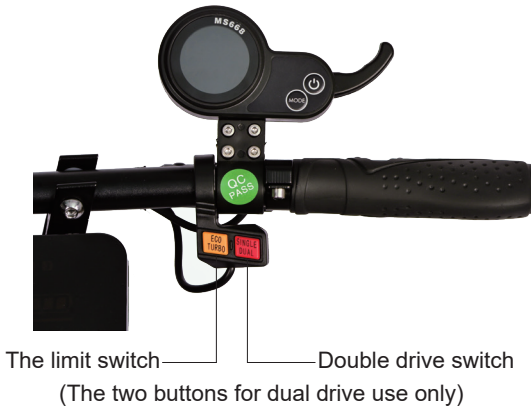

(1) Limit switches and used only for dual drive double drive switch button.

4.The operating instructions:

1.Retract the handlebar

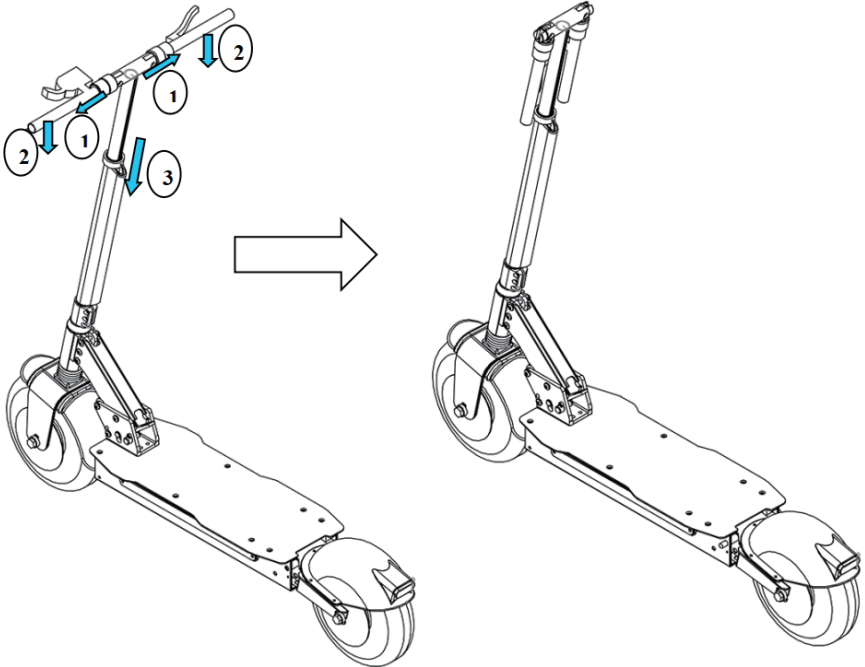

Step 1 Pull the handlebar out of the puller

Step 2 Turn and fold the handlebar

Step 3 Adjust the handlebar to the lowest position

2.Fold / open the frame

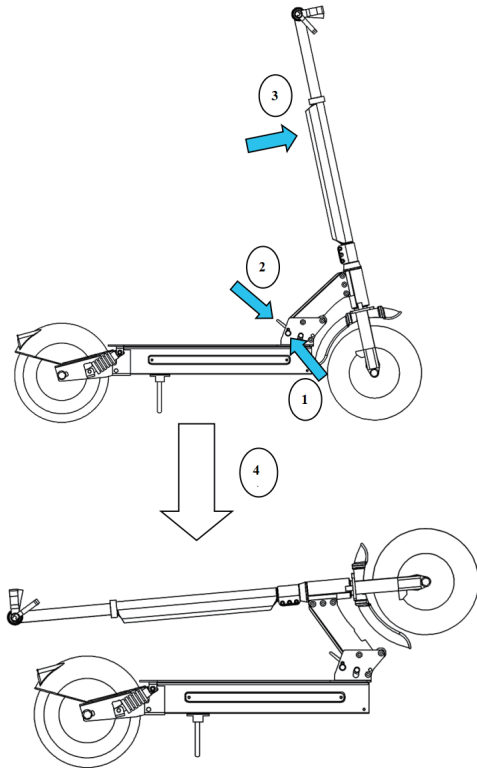

Folding operation: Step 1: Turn the safety lock outwardly, then gently pull out it and put it on the screw on the edge(Figure.). Step 2: Press down the fold button that in the locked position(Figure.). At the same time pull down the Scooter Pole(Figure.). Step 3: Fold the Pole(Figure.).

Opening operation: First, turnTurn the safety lock outwardly, then gently pull out it and put it on the screw on the edge. Then, press the fold button down by hand. Push the lever upwards when press the fold button and. Hear the sound of click then the security lock locked, completing the operation.

3.Operation of multi-function high-definition instrument



- 1.The instrument consists of an acceleration bar, a start switch button, a speed adjustment button and a display screen.
- 2 .Long press the ON / OF button for 3-5 seconds to turn the power on / off.
- 3 The acceleration lever is as shown. Pull down to accelerate, while release to slowdown. Please avoid excessive force in the operation to prevent accidents.
- 4 Press the MODEL, the speed adjustment button, to set the speed of the scooter. There are 3 stalls: high-speed, medium speed, low speed. It can be set according to your own requirements. Below SPEED, it shows the status of the gear, FAS is high-speed, MID is medium speed, SLO is low speed.
- 5 Through the display screen, we can acquire the total mileage of scooters driving, battery power consumption, driving speed. Note: the power consumption of the display screen can only represent the approximate power range. It is only for reference, and it can not accurately measure the power.

5. Announcements

(1) Safe driving

In the acceleration or deceleration time, be aware to avoid the body's gravity in the hand, to avoid the body forward. The standing posture should be keeping your feet one after the other, thus lead to more secure and stable riding.

A. When turning, the body is parallel to the handle. Please pay attention to the road condition before turning. Be sure it is safe and then turn.

B. When the brakes, the gravity center of body backwards. It is better to learn to control the center of gravity when braking. Otherwise it will cause two situations: the car tilted forward, as well as brake and steering system damage.

(2) Charging

1. When charging, please put safe place where children can not touch.
2. The red light indicates charging and the green light indicates charging is complete.
3. If you do not use it for a long time, charge it every 2 months.
4. Do not charge in a damp place.
5. Do not run the motor while charging.
6. Avoid contact with the material leak out of the battery accidentally.
7. Failure to store or recharge in accordance with the correct method may result in damage to the battery and no charge.

6.Fourth: After-sales maintenance

The company's products related to the implementation of three-pack policy.

When the product meet the warranty conditions, we provide free maintenance, replacement and return services. Warranty is provided free, except for delivery and shipping.

(1). In 7 days, when breakdown due to quality problems once confirmed, replacement or return procedures can be carried out.

(2). In 15 days, when breakdown due to quality problems once confirmed, replacement procedures can be carried out.

(3) Please refer to the warranty form for other specific warranty

Note: The following conditions are not a quality issue and do not apply to warranty terms. Agents can provide maintenance services at a cost and maintenance fee.

1. Failure to follow the instructions and precautions
2. Improperly assembled or malfunctioning by improper maintenance by the user
3. Breakdown occur after repair in none Company's network, or the replacement of the original parts of the Company product.
4. Due to wear and tear of the consumables, while the none appropriate replacement maintenance in time, other parts failure and damage occurred.
5. Due to foreign objects puncture or impact, tire leakage or puncture occurred.
6. Damaged due to overload, or through obstructions and extreme movement.
7. Damage due to force majeure (eg, fire house, earthquake, lightning, water damage)
8. Belong to normal use / natural wear parts, do not provide free warranty service

HEZZO

more riding pleasure E-bike E-scooter

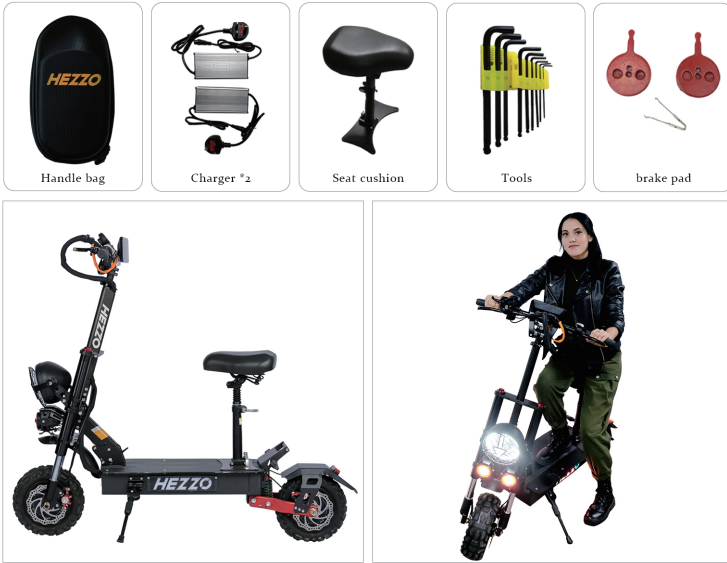

HEZZO

SCOPE AND DURATION OF WARRANTY

+86-152-6866-5909 Marketing03@speedyflyng.com
 @HEZZO +86-152-6866-5909

User name	Sex	Age
Address		
Telephone		
Purchasing address		
Retail price	Odd Numbers	
Commodity name and specification	Model No.	
Dealer Signature	User Signature	

NOT COVERED BY WARRANTY

1. The warranty period has passed.
2. Commercial lease.
3. The gifts presented are not covered by the warranty.
4. Unauthorized modification or disassembly, replacement of accessories causes damage.
5. Warranty will not be provided if the user uses improperly, or is damaged, damaged, watered, or overloaded, causing damage to the accessories.
6. As the factory batch or upgraded parts of electric vehicles will be changed, our company will not notify you separately. Our company guarantees that the changed parts will only improve the quality, please be aware.

Project	Accessories	warranty period	Warranty conditions
Electrical appliances	Motor	6 months	Performance failure
	Meter	12 months	Performance failure
	Controller	6 months	Performance failure
	Battery	12 months	The battery is less than 60% of the original
	Charger	6 months	Performance failure
	Booster	6 months	Performance failure
Basic parts	Turn handle	6 months	Performance failure
	Frame	24 months	There are natural opening and desoldering
	Flywheel	3 months	Performance failure
	Tire	3 months	Natural cracking

HEZZO[®]

more riding pleasure

scooter | E-bike | E-moto

