

# HEZZO<sup>®</sup>

more riding pleasure

scooter E-bike



## User's Manuel

2022-2023

Please read the  
instruction before use



## ABOUT HEZZO

HEZZO is an international brand in UK, EU and US in order to provide high-end qualified ebikes and scooters to the worldwide buyers. HEZZO is designed and produced based on the philosophy of advanced technologies and innovations. We listen carefully to our consumers and investigate each details of improvement .The brand owner, Speedy Flying Group are the direct manufacturer of electric bicycle and scooter since 2006".we accept OEM &ODM orders too!

## GREEN INITIATIVE

HEZZO ebikes are created based on the idea of environmental protection, we wish to protect our planet by changing the method of trip mode.

## MORE RIDING PLEASURE

High-capacity motor coming with original LG/SAMSUNG Lithium battery ,  
Comfortable & elegant designs with full suspension enable to complete a wonderful tour.

## FAST DELIVERY

HEZZO maintain a stable stock in UK、EU and US (under planning) warehouse,the individual order will be dispatched within 72 hours during the working days  
For bulk or OEM orders , please consult us by email.

## HEZZO SERVICE

HEZZO provide 1-2 years' warranty for frames, motors ,batteries for performance failure  
The HEZZO team are ready to react to your request within 24 hours .the HEZZO overseas distribution & service networks in UK、EU、AUSTRALIA、CANADA and US are for display showroom and after-sale services.

---

# INDEX

1. HEZZO ebike family	Page 1
2. Assembly	Page 2
3. User's guidance	Page 3 to 5
4. Hub motor Ebike meters	Page 6 to 8
5. Mid Drive Ebike meters	Page 9 to 11
6. Free Accessories and warranty policy	Page 12

The appearance and colors of the ebikes shall be based on the actual object.

## Chapter I HEZZO ebike family

Covers Fat tyre Ebike, Mountain Bike(Emtb), Folding EBike, Mid drive Ebike(carbon fiber)



HB-20Pro



HB-26Pro



HB-27Pro



HM-27Pro



HM-26Pro



HM-08



HM-527



HB-20S2

### 二、 Exterior scene shooting:





## Chapter 2: Assembly



1. Mounting front handle



2. Mounting front handle



3. Mounting front handle



4. Install the front wheel



5. Install the front wheel



6. Install the front wheel



7. Install the front wheel

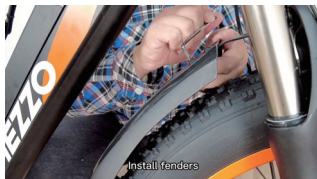

8. Install fenders



9. Install pedal



10. Install pedal



11. Install the headlight



12. Install the headlight

## Chapter 3: Operation guide

1. Does the battery work properly?
2. Is the brake system functioning properly?
3. Is the tire pressure normal?
4. Make sure the bike pipe and saddles are properly adjusted and fastened. Are all the folding joints locked?
5. Are the front and rear wheels locked?
6. Is the gearshift function normal?

### Start cycling

When you start riding, you should turn on the screen and start from low level of PAS. There are three modes of riding with our ebike: pure electric mode, power assisted mode, and manual mode

Make sure you will not exceed the limit of speed according to the local law of road. Please turn on the power before you ride (press CUR for 3-5 seconds), and adjust the power mode minimum

On the premise of ensuring safety, you should minimize frequent braking, to save energy of battery. Please turn off the power when you park the ebike

### Charge the battery

When the voltage is becoming less than half of original one (48V or 36V), please charge the battery in time. The voltage is too low, it will affect the battery life. If you don't use batteries for a long time, please charge the battery once every 2 months, be sure to use

the matching charger provided by us.

Refer to charger indication for charger specification

Make sure the charging time is sufficient up to 4-6 hours in order to do a full charge.

To ensure safety, please do not place the charger and battery where children can touch.

There are no other high power electronic products and flammable and explosive materials around the battery when charging.

## Chapter 4: Maintenance

### Mechanical part

#### 1. Clamping unit

1.1 handlebar, the vertical pipe, saddle pipe must be inserted above the safety line, locking torque should reach 18N.m

1.2 quick dismantling parts, locking thrust should reach 15-17kaf. loose force must be greater than 5kaf

1.3 front wheel nut locking torque to 18N.m, rear nut locking torque to 30N.

#### 2. Lubrication: chain

Flywheel, headset, Indus bowl group needs regular maintenance each month for the chain. A little oil drops into the flywheel position L-AN46GB443. In front of five bowl, bowl group and flower bowl group beads nest parts to add lubricating grease SH/T0386, annually grease.

When adjusting the chain, loosen the nuts at both ends of the rear axle, adjust the front and rear wheel positions, and the chain is suitable for tightness. Use the fingers to pick

the middle part of the lower part of the chain, and move the distance up and down about 10-15mm.

When the front and rear brake wear block have been frequently used, the timely replacement of brake brake pads is required to avoid affecting the braking and wear of aluminum ring.the riding in the rain or snow weather will lead the longer braking of 5 meters.

In order to obtain a smooth gear transmission system, you need check the tension and tightness by turn the adjusting screw or outlet port which will directly affect the transmission effect. The international transmission of "H" for the high speed screw (small flywheel) adjustment of "L" (a large flywheel) for screw speed adjustment

### 3.Motor and all electronic devices

3.1 Make sure the motor and battery is well protected to avoid the long time water soaking of motor.

3.2 pay attention to protect the exposed wire of the vehicle, avoid short-circuit, burn out the controller

3.3 Water flushing through controller is strictly prohibited

### 4. Battery

4.1 Remember only use the chargers provided by HEZZO, non original charger is prohibited to use when charge the battery.

4.2 Be careful of battery drop, impact and extrusion to avoid damage

4.4.Batteries are forbidden to be stored or used in the hot sun or under the high temperature more than 60 degrees. If the battery is not used for a long time, please charge the battery once every two months .

4.5 keep the condition of battery in dry circumstance to avoid humidity or toughing with liquid.

## Chapter 5: The instruction for folding and unfolding (applicable for HEZZO HB-20pro)



1.Release the clamp



2.Release the clamp



3. Unfold the bike  
(you may remove the battery from here too)



4. Release the clamp of the handbar



5. Fold the handbar and the pole



6. The folding is completed.

## Chapter 6: General fault phenomenon and elimination method

1.1 Check the appearance of the bike firstly to find out whether there is broken lead to the exposition of wire or short circuit.

1.2, Check whether the statue of battery is normal and the output voltage, you need to replace a new battery otherwise.

1.3, Check the power switch on the handle is normal, abnormal, you need to replace the switch

1.4, Open the folding structure to see whether there is impurity or bad contact between the battery and controller (applicable for HB-20PRO)

HB-26, HB-27 meters are:M6C



## 1.Appearance size and material (unit: mm)

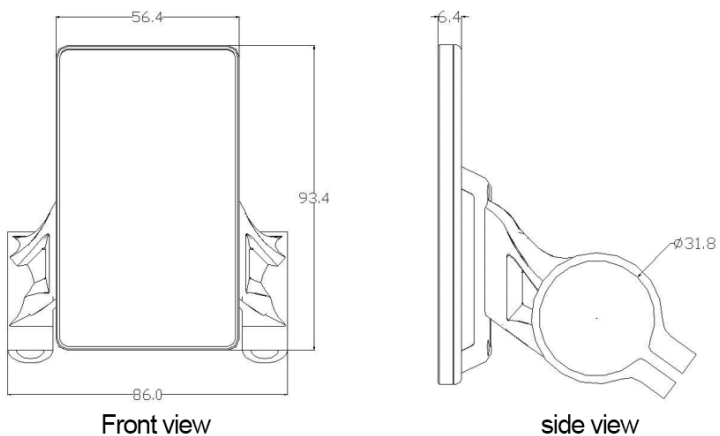

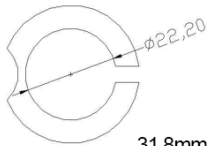

31.8mm bracket with 22.2mm、25.4mm、28.6mm adapter ring optional

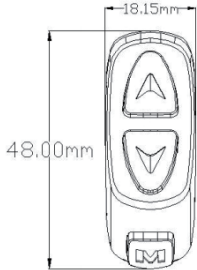

Switch view

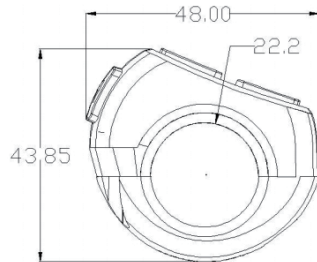

switch side view

### 3.Function Description:

1. Display speed display, steering gear, power indicator, troubleshooting tips, total mileage, single mileage, headlight display, single driving time
2. Control, set the power switch control, headlight switch control, 6 km/h set point control, wheel diameter and top speed setting, automatic idle sleep time setting, backlight brightness setting, set voltage level
3. Communication protocol: UART

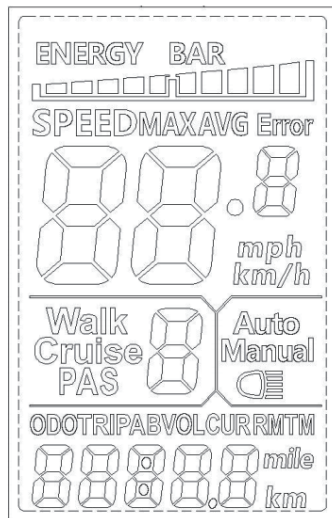



It can be manually turned on by the instrument and automatically turned on by the ambient brightness (light sensing support is required).



Battery level display



Walking boost mode;  
Cruise control mode;  
Power gear :0-9 adjustable;



Maximum speed MAX, average speed AVG; MPH, KM/H;  
The meter will calculate the true speed based on the wheel diameter and signal data

## 4.The key introduction



- 1.When riding, need to modify power speed gear, short click
  - 2.When riding, switch the multi-function area display data, short click
- Single key long press is mainly used for mode/switch state switching compound key (long press) is used for parameter setting, because the operation is complicated, so it can reduce the error operation 1(short press does not make compound key, because it is easy to trigger the operation by mistake, it is too difficult to do)



## HM-26Pro meters are:DPC18 MANUAL



## INTRODUCTION

The DPC18 display includes the functions shown below:

Multiple Power Assist Levels

Walk Assist (slow speed motor assist)

Distance and Odometer (TRIP/TOTAL)

Backlight / Headlight

Speed based on current riding conditions

Error codes

Power meter (Watts or Amps)

Battery Gauge (Voltage or Percentage)

Note: Voltage is recommended for a more accurate battery capacity estimation USB charging port 5V at 0.5A (for small electronics not enough for a light)

### Notes:

Storage humidity 30 – 70%

Operating temperature -4°F to 140°F

IP65 waterproof



## BUTTONS

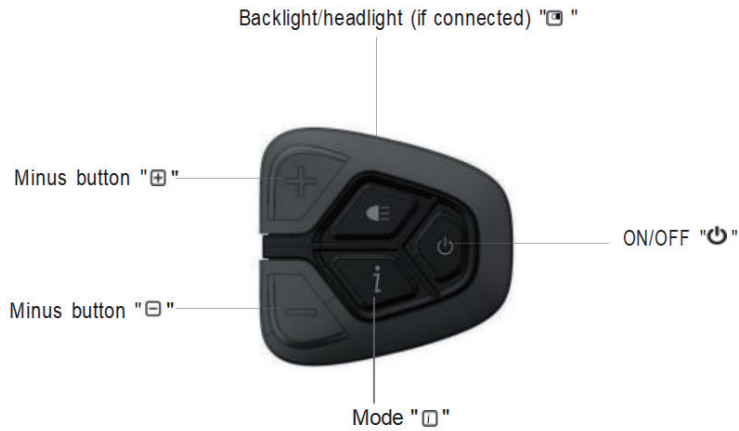

## OVERVIEW DRAWING



## HARDWARE

The DPC 18 Display comes with all of the necessary hardware to mount on your handlebars. You simply decide where you would like to install it on your handlebars and use the appropriate hardware to attach it.

1 Display Unit



2 M3 0.5 x 12 mm Bolts  
(Display Bracket Bolts)



3 Rubber Grommets



## SPECIFICATIONS

- Maximum operating current: 30mA
- When power off, leak current is less than: 1uA
- Operating current supplied to controller: 50mA
- Operation temperature: -4°F~113°F
- Storage temperature: -22°F~158°F
- IP level: IP65
- Storage humidity: 30%-70%

### CAUTION



Avoid collisions to prevent damage or malfunction.



The unit is IP65 water resistant.



During installation do not overtighten the bolts as this will break the brackets!



Bolts provided with display are:

3 – M3 0.5 x 12mm (Control pad hardware and Mount bracket hardware)

## INTERFACE

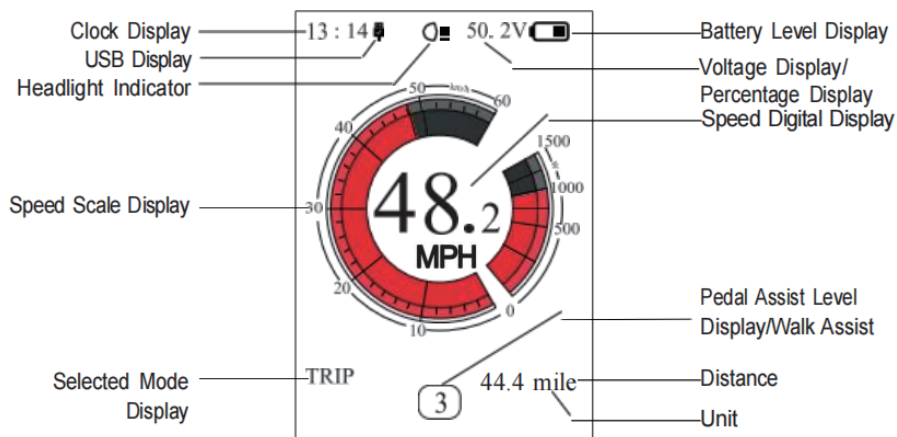

## 7/8 FREE ACCESSORIES

1  
GIFT



**HIGH-END INFLATOR**  
Stainless steel

2  
GIFT



**FENDER**  
Perfect protection from mud and water

3  
GIFT



**SUN-GLASSES**  
With a glasses box

4  
GIFT



**LEATHER SEAT**  
Comfortable with tail lights

5  
GIFT



**METAL PHONE HOLDER**  
Solid&heavy duty

6  
GIFT



**LED light(300LM)**  
superbright for your safety

7  
GIFT



**Rear rack**  
Applicable for HS-20

8  
GIFT



**TOOL**  
Install electric bike tools



## SCOPE AND DURATION OF WARRANTY



+86-152-6866-5909



Marketing03@speedyflyng.com



@HEZZO



+86-152-6866-5909

User name		Sex		Age	
Address					
Telephone					
Purchasing address					
Retail price	Odd Numbers				
Commodity name and specification	Model No.				
Dealer Signature	User Signature				

### NOT COVERED BY WARRANTY

- 1.The warranty period has passed.
- 2.Commercial lease.
- 3.The gifts presented are not covered by the warranty.
- 4.Unauthorized modification or disassembly, replacement of accessories causes damage.
- 5.Warranty will not be provided if the user uses improperly, or is damaged, damaged, watered, or overloaded, causing damage to the accessories.
- 6.As the factory batch or upgraded parts of electric vehicles will be changed, our company will not notify you separately. Our company guarantees that the changed parts will only improve the quality, please be aware.

Project	Accessories	warranty period	Warranty conditions
Electrical appliances	Motor	12 months	Performance failure
	Meter	12 months	Performance failure
	Controller	6 months	Performance failure
	Battery	12 months	The battery is less than 60% of the original
	Charger	6 months	Performance failure
	Booster	6 months	Performance failure
	Basic parts	Turn handle	6 months
Frame		24 months	There are natural opening and desoldering
Flywheel		3 months	Performance failure
Tire		3 months	Natural cracking

# HEZZO<sup>®</sup>

more riding pleasure

scooter E-bike

